

Green Forest Cabinetry is thrilled to be adding these fabulous new offerings to our lineup, that are sure to be a home run on your next job!

On July 1st, Green Forest Cabinetry will be launching new Design Catalogues and a new Specification Book that will have all of these products ready to order.

If you need assistance or have any questions, please reach out to our amazing customer success team at 757-485-9200.



Park Place in Bianco

You asked for a softer white, and we listened! Bianco will have full SKU coverage, just like White, and a standard lead time.



Bella in Smoked Cashew

Natural Stains are IN. We're excited to bring one of best trending colors to the affordable Bella Plus series.

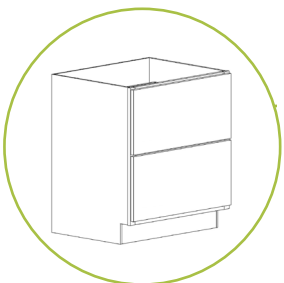

Two Drawer Base Cabinets

Two Drawer Base Cabinets with extra deep drawers. Available in 30 and 36 wide, in all colors and doorstyles.

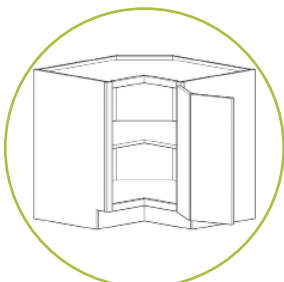

Base Easy Reach 33"

Our timeless Base Easy Reach, now in 33" wide. This will be available in all colors and doorstyles.

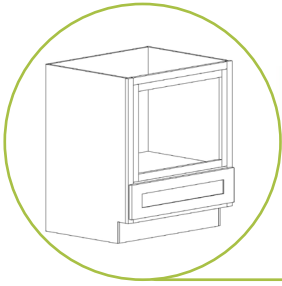

Base Microwave/Oven Cabinet

Specifically designed to fit Microwave Drawer Appliances. Available in 24", 27" and 30" wide. This SKU comes with a "pack out kit" that allows the installer to flush the opening with the appliance for a built in look.

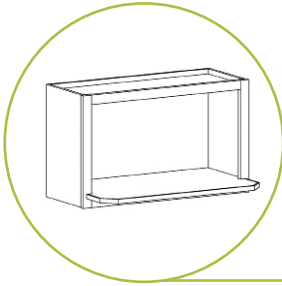

UPDATED Wall Microwave Shelf

We've updated our Microwave shelf to have a 19" deep shelf to accommodate today's bigger microwaves.

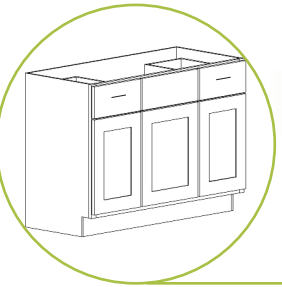

Vanity Combo 54"

Introducing 54" Wide Vanity Combos. A highly requested SKU, that will be available in our Bella Plus series.



Vanity Combo 60"

Introducing 60" Wide Double Bowl Vanity Combos. A highly requested SKU, that will be available in our Bella Plus series.

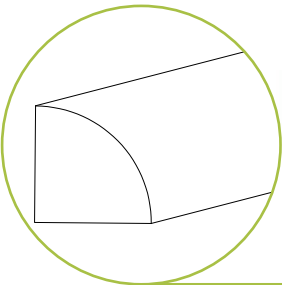

Quarter Round

3/4" Tall Quarter Round will be available in all colors. This sought after piece will allow designers to tie in the the kitchen trim, with the existing home's millwork.



C.A.B. Blender

This product is designed to blend the spray line of an opaque aerosol. This product contains a blending formula that is ideal for blending spray lines, blending overspray and blending minor surface scratches.

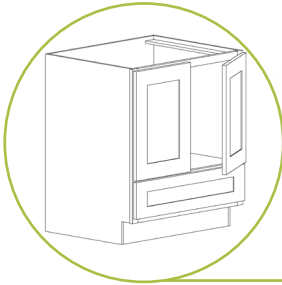

MODIFICATION- Invert Base Cabinet

This modification is perfect for Vanities or Sinks looking to have a little extra storage, inverting the cabinet to have a functioning drawer on the bottom.

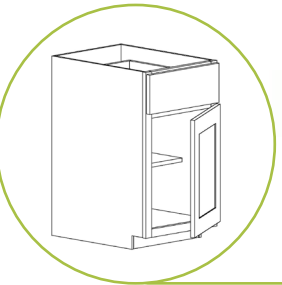

MODIFICATION- Reduce Toekick to 2.5"

Remove all height concern doubts with this modification, allowing more space for material- like standalone tall pantries- that would otherwise be difficult to fit into certain spaces.



MODIFICATION- Add Tray Divider to Cabinet

This Modification applies to Wall Refrigerators and Oven Cabinets, allowing designers to give their customers a more functional use for a difficult space to use.

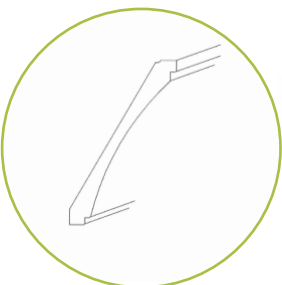

6" Crown Moulding

Introducing a 6" tall crown moulding. Using this along with the 7/8" reveal on our wall and tall cabinets, installers can simply tack this crown onto our 45" uppers without a buildup, and scribe the uppers to the top of a nine foot ceiling.

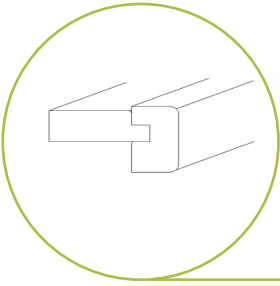

Stack- Rail

You know we are very proud of our seamless stacked cabinets! To offer more flexibility, a Stack Rail allows designers to stack any wall cabinets- and keep consistent reveals throughout the run.

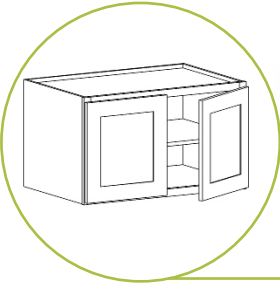

Wall Refrigerators in Specialty Colors

Introducing our two most popular refrigerator SKUs, WR3621 & WR3612, will be available in Green, Blue and Midnight.



Vanity Wall Open Shelf in Specialty Colors

With the addition of the VWOS in our specialty colors, many customers can now have the on trend bathroom they have been looking for.



Oven Cabinets in Specialty Colors

Rounding out our on trend program, Oven Cabinets will now be available in Norfolk Blue, Seadance Green, and Midnight.

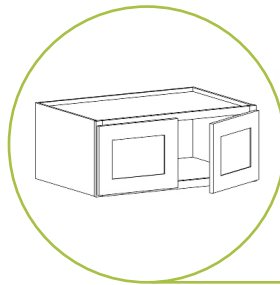

Wall 24 15 and Refrigerator Wall 24 15

Offering this stand alone W2415 allows designer to more easily manage continuing runs with our very popular door over door cabinets



**BELLA
SKU
ADDITIONS**

Step Your Customers Game Up with These!

The Bella Plus series is a highly sought after cabinet, with a very low price and high quality value. To make it easier to design and sell, we are adding the following SKU's to Bella; BD336, BLS33, WER30 & 39, WDC15D, BFS33 & 36, OC3384, BCLIP.

As always, we appreciate your partnership, and thank you for your continued business.