

 **RiverRun**[™]
CABINETS

A Natural Choice for the Home.



New Colors!





Located in the beautiful Shenandoah Valley of Virginia, where we are surrounded by majestic mountains and rolling hills rich with color. Our people are genuine with a true appreciation of their history and roots. Here lies the inspiration for RiverRun Cabinetry.

This is home.

What makes RiverRun cabinetry such an outstanding investment? Our relentless commitment to creating a naturally beautiful, fully featured line of cabinets and an approach that combines traditional construction and hand finishing techniques with the efficiencies of contemporary production. RiverRun is where beauty, style, and quality meet to provide the best cabinet for the very best value.





Cambridge Pewter



CAMBRIDGE

Cambridge is RiverRun's most popular door style with beautiful paint options on the timeless shaker door and five-piece drawer front. The simple lines provide a rich playground in which to explore colors and color combinations which make this style a designer favorite.

Cambridge Series

Available in these popular paint color options



White



Linen



Mint



Sage



Pewter

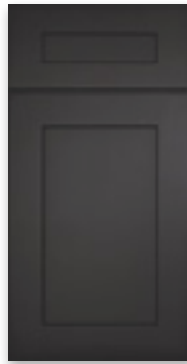

Onyx



Blue Lagoon



Cambridge White

Kellie Hockstra, Williams Studio, Kentwood, MI

CAMBRIDGE CONSTRUCTION:

Full overlay, all wood construction with premium MDF painted doors. Soft-close doors and drawers. Dovetail solid wood drawers with five-piece drawer fronts.



Cambridge Mint Island with Cambridge White Cabinets





Dalton Gray

DALTON

Dalton is one of RiverRun's most popular door styles with a graceful stain on a shaker door and five-piece drawer front. The rich stain choices allows hints of the wood graining and color to show through and works beautifully on it's own or pairs well with other styles to compliment any kitchen design.

Dalton Series

Available in these popular stain options

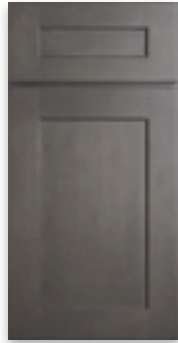

Gray

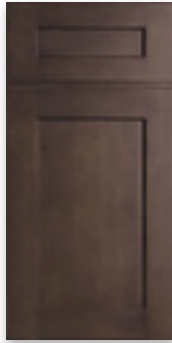

Cocoa

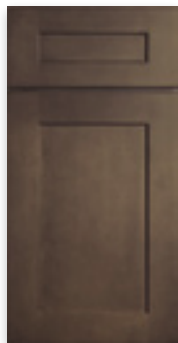

Chestnut



Dalton Cocoa

Gabby Koontz, Classic Kitchen and Bath, Harrisonburg, VA

DALTON CONSTRUCTION:

Full overlay, all wood construction. Soft-close doors and drawers. Dovetail solid wood drawers with five-piece drawer fronts.

COMING SOON TO RIVERRUN!



RiverRock

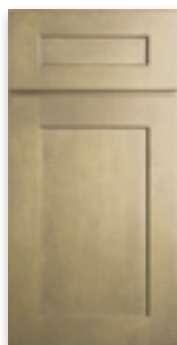

Sahara



Dalton Gray

Cathy Pitts, Classic Kitchen and Bath, Harrisonburg, VA



Leigh Jones, Classic Kitchen and Bath, Harrisonburg, VA



HAMPTON LINEN

Soft Alluring Elegance



Mark Welch, Kitchen & Bath Creations, Brandon, FL



Jim Inman, Williams Studio, Kentwood, MI

Your style – comfortable yet sophisticated. Your kitchen is a place where friends and family gather, rich with voices, cooking creativity, and the rhythm of daily living. Hampton Linen Glazed, the creamy white finish evokes the feeling of a French Country Kitchen.



HAMPTON LINEN CONSTRUCTION:
 Full overlay, all wood construction with premium MDF painted doors and applied molding. Soft-close doors and drawers. Dovetail solid wood drawers with five-piece drawer fronts.



LENOX CHESTNUT

Timeless, Warm and Elegant





Cathy Pitts, Classic Kitchen and Bath, Harrisonburg, VA

There's nothing like coming home to that sense of richness that envelops you and connects you to family and friends.

The warm and rich color of Lenox Chestnut will evoke a sense of familiar ease that invites you to live more comfortably in the space. Lenox Chestnut is a visual treat with its intricate layers and details.



LENOX CHESTNUT CONSTRUCTION:

Full overlay, all wood construction with applied moulding. Soft-close doors and drawers. Dovetail solid wood drawers with five-piece drawer fronts.





PREMIUM QUALITY CONSTRUCTION

RiverRun Standards

RiverRun Cabinetry's Standard Construction offers many features which are considered upgrades in other lines of cabinetry.

- All Wood Construction
- Dovetail Solid-Wood Drawers
- Fully Extendable Drawer Glides
- Soft Close Doors and Drawers
- 6-Way Hinges
- Natural Wood Interiors
- 3/4" Shelves
- Full Backs

Sides 1/2" plywood with the option for finished ends.

The interior features a clear-coat finish.

Shelves are 3/4" thick birch veneered plywood.

Sealed with a clear-coat finish, adjustable and front edge banded.

For ease of installation, backs are solid 1/2" plywood.

Base cabinet backs extend to the floor providing optimal structural stability.

Drawer boxes are solid hard wood with dovetail joints and clear-coat.

Bottoms are birch plywood fully captured. Glides are under mount, full extension soft-close.

Traditional face frame construction using select birch. Face frames are solid 3/4" thick with 1-1/2" stiles and rails. Mortise and tenon joints.

Hinges are 6-way adjustable.

Optional roll-out trays. All wood dovetail construction.

Premium full overlay door styles with soft-close door options.

Butt doors on all sizes up to 39" wide.

*Standard cabinet does not include finished ends, however can be added.

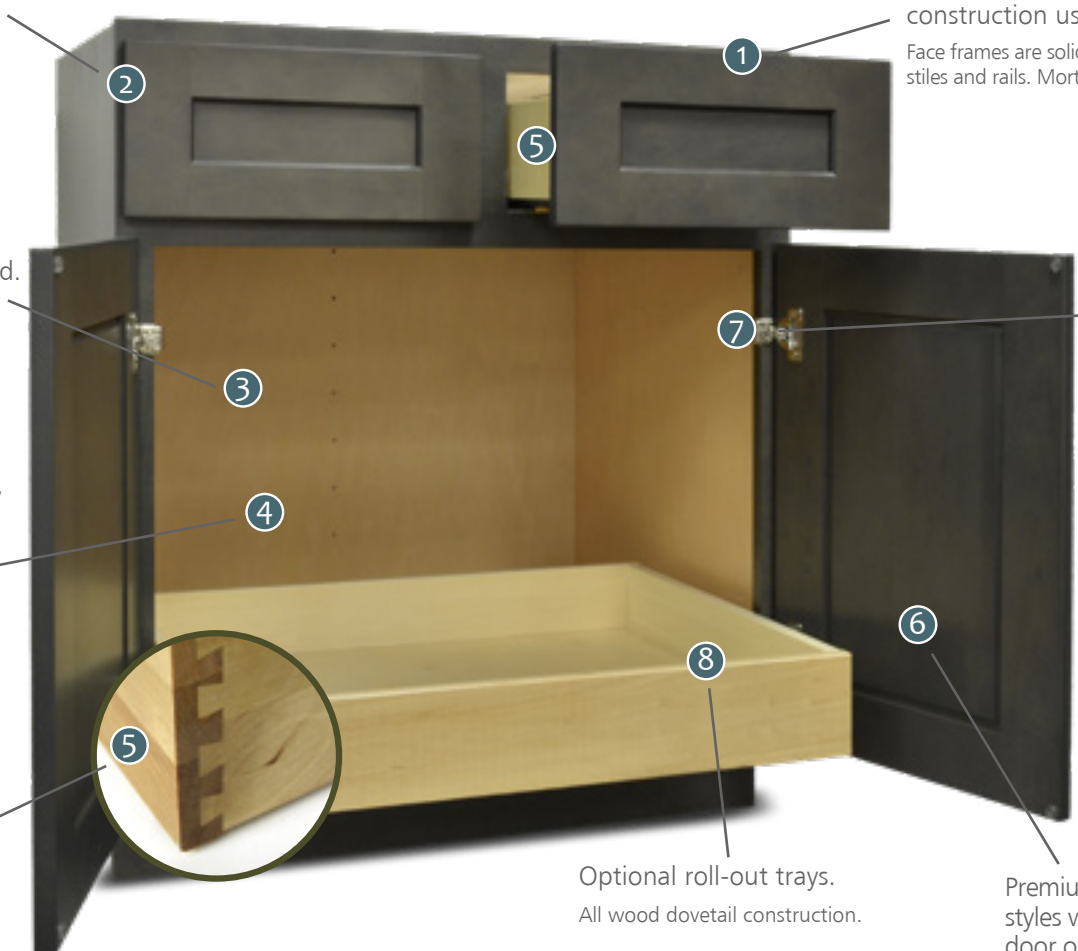

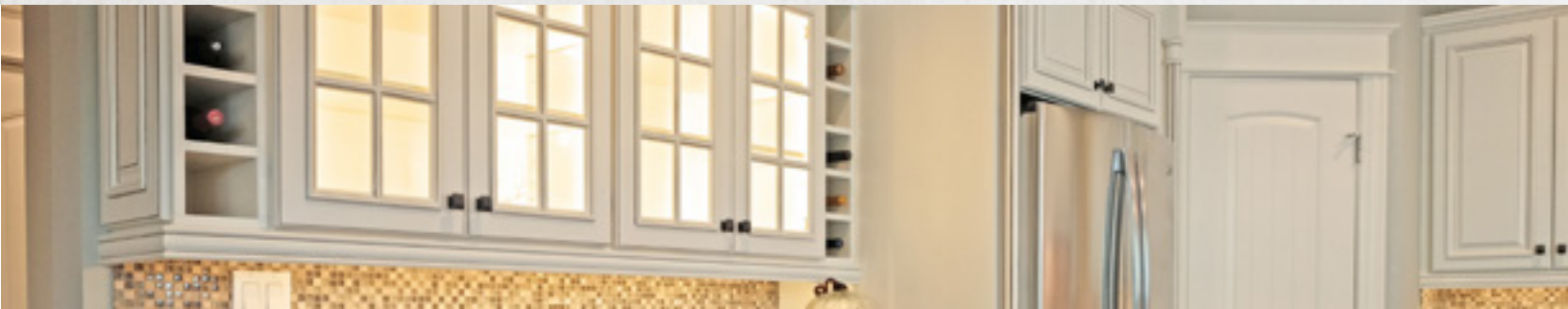

QUALITY

RiverRun believes in beautiful cabinetry that is inviting and affordable. We produce a stylish, fully featured line of cabinets with a process that combines traditional construction and hand finishing techniques. It is in this process where beauty, style, and quality meet to provide the best cabinet for the very best value.

Only premium materials are used in the creation of RiverRun cabinetry. They are crafted using time honored woodworking methods. Every door, face frame, drawer head, and virtually every piece of the cabinet is inspected by our experienced Quality Control team.

TEN YEAR LIMITED WARRANTY

We guarantee your RiverRun cabinetry and ensure that all component parts and hardware are free from defects in material and workmanship under normal use to the original owner for 10 years.

CONSTRUCTION

RiverRun Cabinetry's Standard Construction offers many available features which are considered upgrades in other lines of cabinetry: all wood construction; plywood shelves; solid wood, dovetail drawers; real birch-veneered interiors; full extension, soft-close drawer glides; full overlay soft-closed doors. All these features are completed with a gorgeous, durable finish.

FINISH

We use deep, luxurious, and durable finishes and our glazes add a rich patina, enhancing the door's details. Additionally, all our finishes have anti-yellowing properties, keeping the cabinet surface looking great for years to come.

SELECTION

RiverRun Cabinetry has carefully selected door styles that inspire... from traditionalists to the contemporary to the avant-garde.

LEARN MORE

Visit our website for more information and details:
www.RiverRunCabinetry.com

ACCESSORIES & FINISHING TOUCHES

Decorative Options

MOULDINGS



2 3/4" Crown Moulding
CM8



Large Cove Moulding
CROWNCOVE



Shaker Crown Moulding
SHAKERCROWN



Large Crown Moulding
BCM8



Base Moulding
BASEMLD



5/8 Scribe Moulding
SM8



Small Cove Moulding
COVE



Shoe Moulding
SHOEMLD



Batten Moulding
BATTEN



Light Rail Moulding
LR8



Outside Corner Moulding
OCM8



135 Outside Corner Moulding
OCM135-8

MULLION DOORS



Mullion Doors
MULL
(Not available in Desoto and Dalton Gray)

PREP FOR GLASS



Prep for Glass Doors
PFG
(Glass not included)

TULIP & BUN FEET



TULIPBUNFOOT



BUNFOOT

VALANCES



Beckony Valance
V31D, V37D, V43D



Arched Valance
V31E, V37E, V43E

CORBEL



PLAIN CORBEL
PLCOR

CORNER APPLIANCE GARAGE



ADAG
Note: Single door hinged to side stile

Workstation Options

BOOKSHELVES



48"H/54"H/60"H/66"H

Bookcases:

BU1848S, BU1854S, BU1860S,
BU1866S, BU2448S, BU2454S,
BU2460S, BU2466S, BU3048S,
BU3054S, BU3060S, BU3066S,
BU3648S, BU3654S, BU3660S,
BU3666S

84"H/90"H/96"H

Bookcases:

BU1884S, BU1890S, BU1896S,
BU2484S, BU2490S, BU2496S,
BU3084S, BU3090S, BU3096S,
BU3684S, BU3690S, BU3696S

ROLL-OUT TRAY



ROT B15 ,ROT B18 ,ROT B21, ROT B24, ROT B27,
ROT B30, ROT B33, ROT B36

FLOATING SHELVES



Available Widths

24", 30", 36"

Shelves are 10" deep and come with installation bracket.

WINE RACKS



12" D Wall Wine Racks

WR3018
(Horizontal Installation)

WR1830
(Vertical Installation)

Note: Holds 18 to 20 bottles



Wine Cubbies
WCU30

Note: Can be installed
vertically or horizontally

SHELVES



30" and 42" X 12" D
1/4 Round Shelves

30" Shelves–WQR630
42" Shelves– WQR642

ORGANIZATIONAL SHELF



12" D Wall Organizers and Shelves
WO306
WO366 (pictured)

MICROWAVE WALL CABINET



MWS3018X12
18" H X 12"
NOTE: SHELF IS 17" D



Organizational Options

TRIMMABLE WOOD CUTLERY TRAYS



14 5/8"W X 22"D
Wood Cutlery Tray
4WCT-1SH
20 5/8"W X 22"D
4WCT-3SH



18 1/2"W X 22"D
Utensil Organizer
4WUT-1SH
24"W X 22"D
4WUT-3SH



Trim to fit base cabinet drawers. Natural finish

BASE FILLER PULL OUT



3" Base Filler
w/(4) 1/4" x 23" Shims
432-BF-3C-RR
6" Base Filler
w/(4) 1/4" x 23" Shims
432-BF-6C-RR

Designed to fit between two base cabinets, a base and tall cabinet or a base cabinet and a base end panel. Front Filler not included.

PULL OUT WASTE CONTAINER



Single 35 Qt
Waste Container
4WCTM-12DM1-21
White Container Fits
in Base 15



Double 35 Qt
Waste Container
4WCTM-18DM2-18
White Container Fits
in Base 18

Not available in soft-close.

WALL FILLER PULL OUT



3" Wall Filler 30" High
432-WF-3C-RR
3" Wall Filler 36" High
432-WF36-3C-RR
3" Wall Filler 42" High
432-WF42-3C-RR



6" Wall Filler 30" High
432-WF-6C-RR
6" Wall Filler 36" High
432-WF36-6C-RR
6" Wall Filler 42" High
432-WF42-6C-RR

Designed to fit between two wall cabinets, a wall and tall cabinet or a wall cabinet and a wall end panel. Front Filler not included. All units include (4) 1/4" x 11" Shims.

U-SHAPED TRAY DIVIDER



12" Chrome Tray Divider
LD-597-12CR-10
18" Chrome Tray Divider
LD-597-18CR-10
Can be used in wall or base cabinet

TRIMMABLE SPICE ORGANIZER INSERT



16"W X 19 3/4"D
Spice Organizer
4SDI-18
22"W X 19 3/4"D
Spice Organizer
4SDI-24
Trim to fit base cabinet drawers. Natural Finish

BASE ORGANIZER PULL OUT



Base Organizer
w/Adjust. Shelves
448-BC-5C-28
Fits in B9 cabinet

WOOD PANTRY PULL OUT



43" H x 14" W
Wood Pantry w/Slide
448-TP43-14-1
Fits in 18" Pantry Cabinet.
Has the following features:

- 450 lb rated soft-close slide
- Adjustable shelves
- Limited Lifetime Warranty

Organizational Options

WOOD LAZY SUSANS



20" Banded Wood
D Shaped Susan
LD-4BW-201-20SBS-8



28" Banded Wood
Kidney Susan
LD-4BW-401-28SBS-40

Both Susans attach to cabinet floor and have a steel bearing. They fit wall and base corner cabinets.

POLYMER LAZY SUSANS



28" Polymer Kidney
2 Tray
LD-2472-28-11-1



20" Full Circle
2 Tray Set
3072-20-11-52
20" Full Circle
3 Tray Set 33" 41"
3073-20-11-531
20" Full Circle
3 Tray Set 38" 46"
3073-20-11-536

Both Susans attach to cabinet floor and have a steel bearing. They fit wall and base corner cabinets.

WHITE POLYMER TILT OUT TRAY



11" TILT OUT TRAY KIT WHITE
LD-6572-11-11-1

14" TILT OUT TRAY KIT WHITE
LD-6572-14-11-1

UNDER-SINK DRIP TRAY

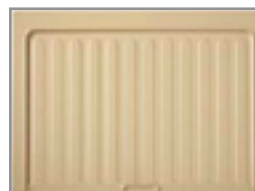

36" Sink Base Drip Tray
SBDT-3336-A-1

Will fit SB33 or SB36.
Must be trimmed to fit.
Install before plumbing the sink.

You can trust a RiverRun designer.

Our dealers understand the importance of quality cabinets therefore we strive to support them and their designers not only in service but also in their creativity. We are always working towards expanding our options and product line. Don't see the options you are looking for here? Just ask! Our dealers are fully trained in our complete product line and have lots of creative options to customize your space.



The photos in this brochure are reasonably accurate for color and detail. Some customization may have been added.





Cambridge Onyx

 **RiverRun**[™]
CABINETS
riverruncabinetry.com

Ask your RiverRun dealer about special order options.

